

Post & Rail Narrow Kit - 80322

mimSAFE

mimclip.mimsafe.com

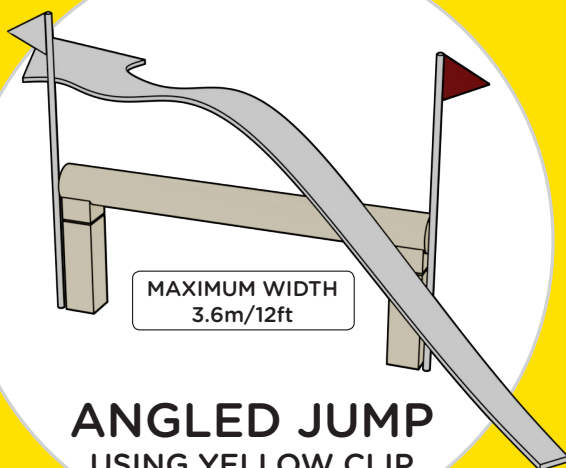
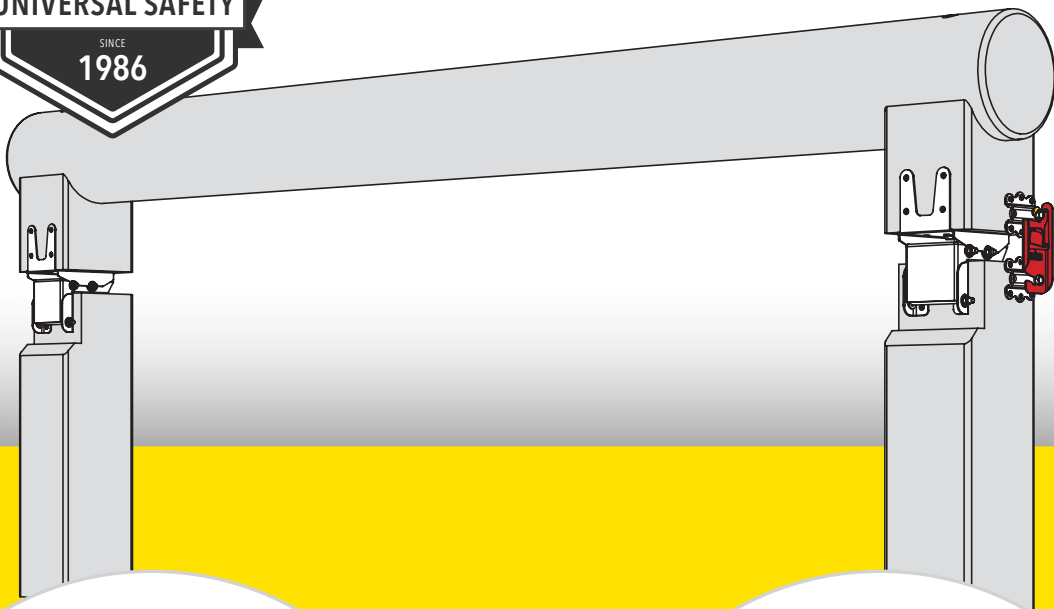

ANGLED JUMP
USING YELLOW CLIP

order separately
kit nr.80328

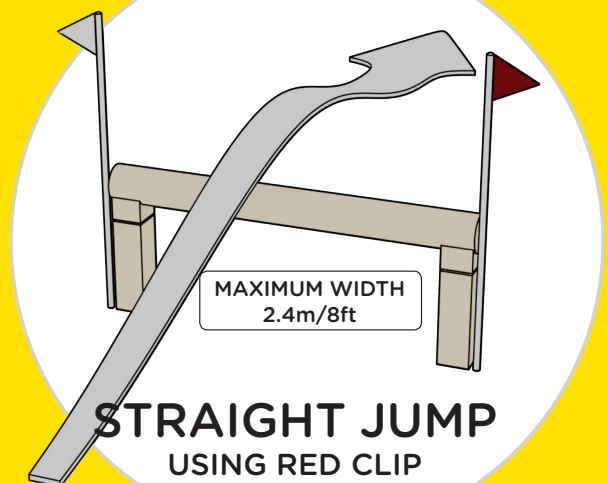

STRAIGHT JUMP
USING RED CLIP



included in this kit

INFORMATION ABOUT THE POST & RAIL NARROW KIT

The Post & Rail Narrow Kit has been designed and developed specifically to greatly reduce the risk of rotational falls. The most important element of this kit is that it will not

break the fence or risk injury to the horse if hit vertically. The rail is only released when impacted horizontally by the horse. The risk of a resulting rotational fall is thus reduced.

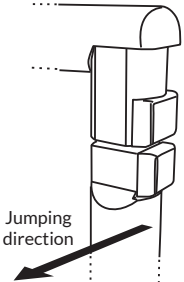
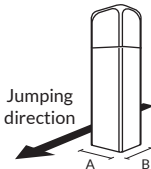
FENCE DIMENSIONS

<div>ROUND POST</div> <div></div> <div>Jumping direction</div> <div><table><tr><th colspan="2">DIAMETER</th></tr><tr><td>9 - 11</td><td>inch</td></tr><tr><td>225 - 275</td><td>mm</td></tr></table></div>	DIAMETER		9 - 11	inch	225 - 275	mm	<div>SQUARE POST</div> <div></div> <div>Jumping direction</div> <div>A: MIN-MAX SIZE</div> <div><table><tr><td>6 - 8</td><td>inch</td></tr><tr><td>150 - 200</td><td>mm</td></tr></table></div> <div>B: MIN-MAX SIZE</div> <div><table><tr><td>8-9</td><td>inch</td></tr><tr><td>200-225</td><td>mm</td></tr></table></div>	6 - 8	inch	150 - 200	mm	8-9	inch	200-225	mm	<div>TOP SECTION ANGLED JUMP</div> <div></div> <div>MIN-MAX WEIGHT</div> <div><table><tr><td>175 - 240</td><td>lb</td></tr><tr><td>80 - 110</td><td>kg</td></tr></table></div> <div>MIN-MAX DIAMETER</div> <div><table><tr><td>8 - 12</td><td>inch</td></tr><tr><td>200 - 300</td><td>mm</td></tr></table></div> <div>MAXIMUM LENGTH</div> <div><table><tr><td>12</td><td>ft</td></tr><tr><td>3600</td><td>mm</td></tr></table></div>	175 - 240	lb	80 - 110	kg	8 - 12	inch	200 - 300	mm	12	ft	3600	mm	<div>TOP SECTION STRAIGHT JUMP</div> <div></div> <div>MIN-MAX WEIGHT</div> <div><table><tr><td>165 - 200</td><td>lb</td></tr><tr><td>75 - 90</td><td>kg</td></tr></table></div> <div>MIN-MAX DIAMETER</div> <div><table><tr><td>8 - 12</td><td>inch</td></tr><tr><td>200 - 300</td><td>mm</td></tr></table></div> <div>MAXIMUM LENGTH</div> <div><table><tr><td>8</td><td>ft</td></tr><tr><td>2400</td><td>mm</td></tr></table></div>	165 - 200	lb	75 - 90	kg	8 - 12	inch	200 - 300	mm	8	ft	2400	mm
DIAMETER																																									
9 - 11	inch																																								
225 - 275	mm																																								
6 - 8	inch																																								
150 - 200	mm																																								
8-9	inch																																								
200-225	mm																																								
175 - 240	lb																																								
80 - 110	kg																																								
8 - 12	inch																																								
200 - 300	mm																																								
12	ft																																								
3600	mm																																								
165 - 200	lb																																								
75 - 90	kg																																								
8 - 12	inch																																								
200 - 300	mm																																								
8	ft																																								
2400	mm																																								

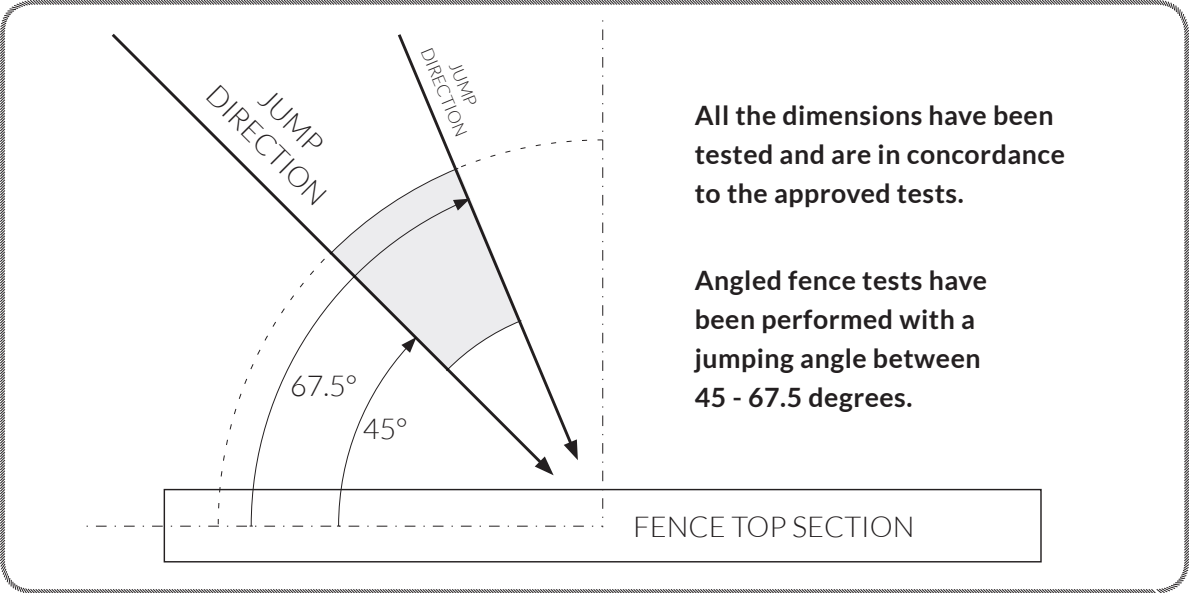

It is essential to follow the recommended dimensions on the fence for the correct function. If the recommended procedure is not correctly followed it may cause the failure of the device.

For your own safety and that of others please note the following step by step advice for correct preparation and installation. It is important that you follow your own health and safety requirements when constructing this kit.

Ensure that you have all parts of the Post & Rail Narrow Kit.

Be aware of the risk of injury when handling heavy rails, posts and the tools for mounting.

WARNING!

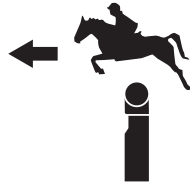

Jumping direction



IMPORTANT

The clips must be placed on **ALL** posts.



IMPORTANT

The posts must be:
VERTICALLY LEVELLED TO GRAVITY USING A SPIRIT LEVEL OR A CONSTRUCTION PLUMMET

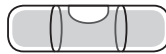

IMPORTANT

The posts must be:
PARALLEL, & FRONTAL ALIGNED & SECURED TO THE GROUND

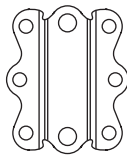
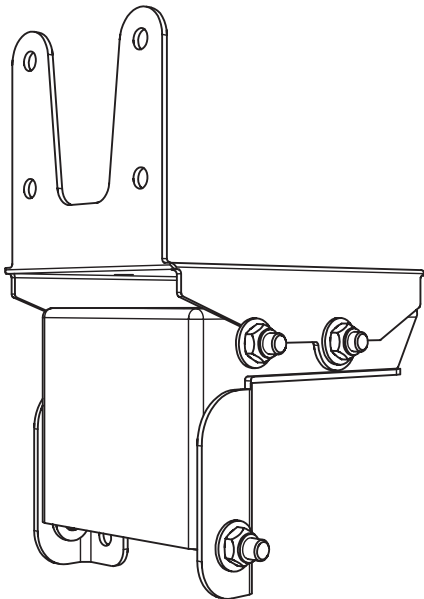

A	00454	2x
	Part no	

B	F70A	4x
	Part no	

D	F18C	6x
	Part no	

C	F18F	6x
	Part no	

M-TS10X90 4X	POST TOP SECTION 2X	POST BOTTOM SECTION 2X	RAIL 1X
	not included	not included	not included

STEP
1a

Square posts

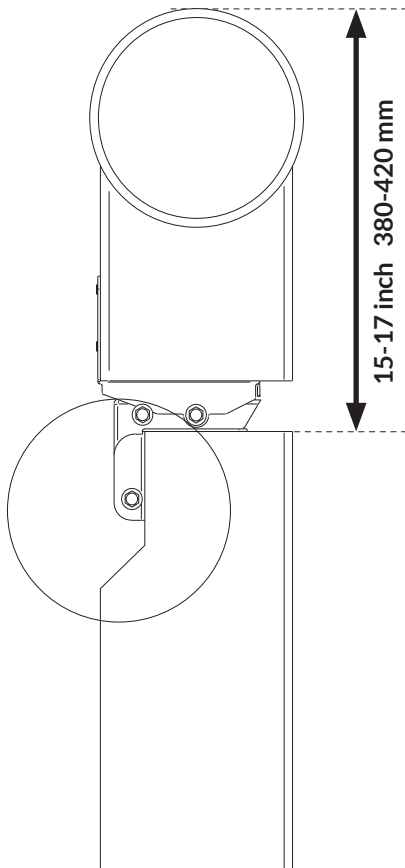
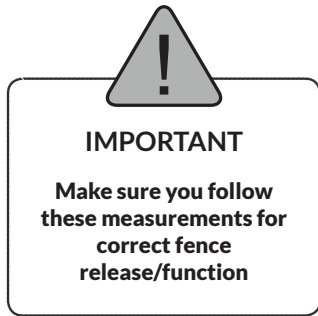
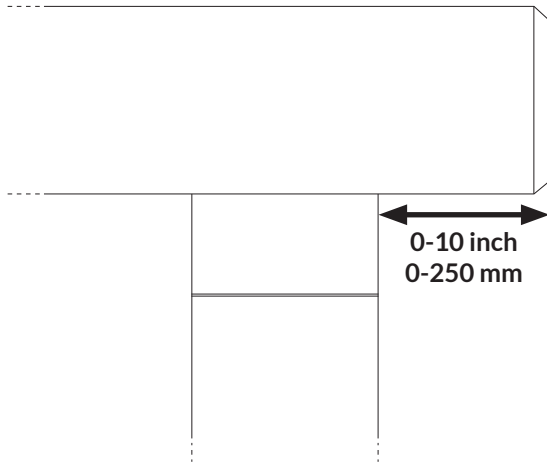

2X

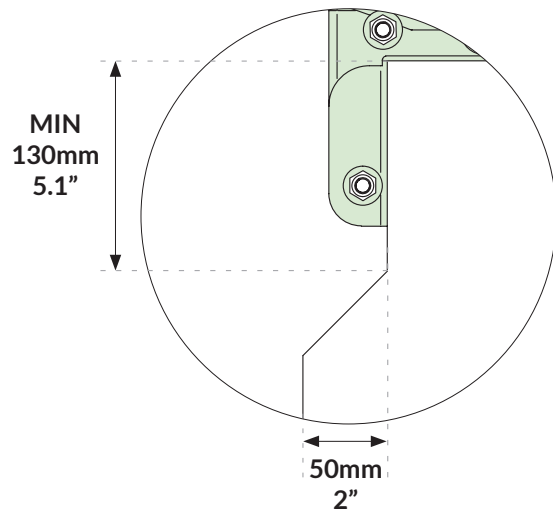
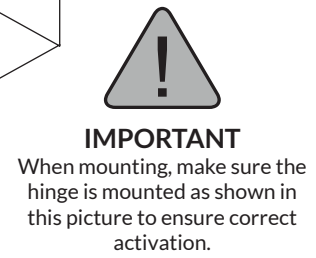
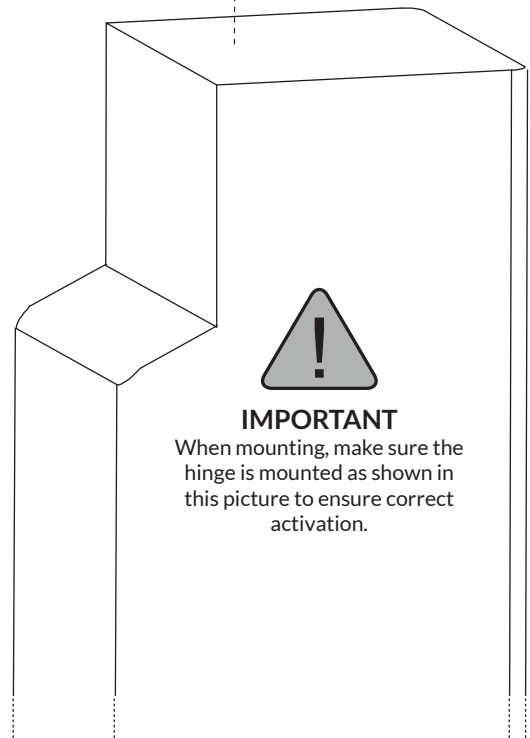
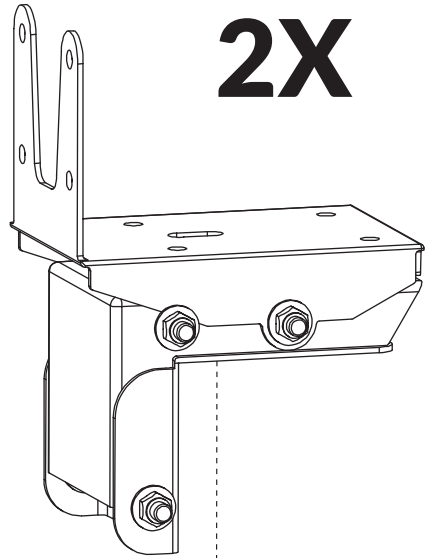

STEP
1b

Round posts

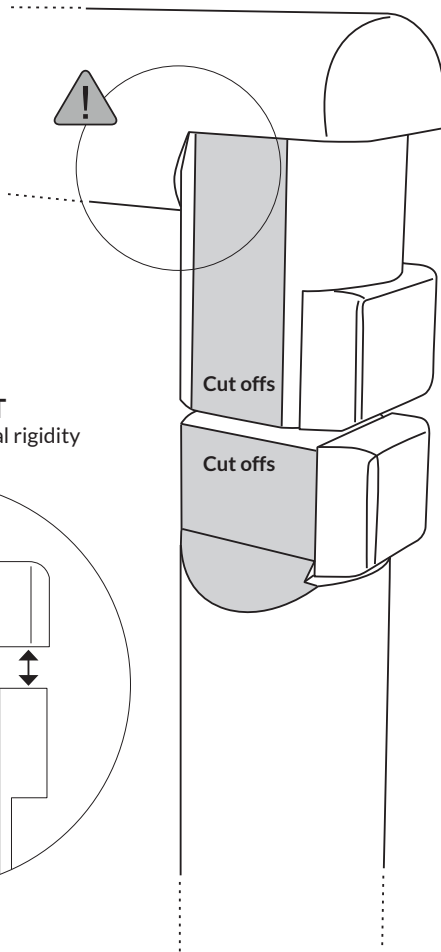

IMPORTANT
Aligned cuts for torsional rigidity

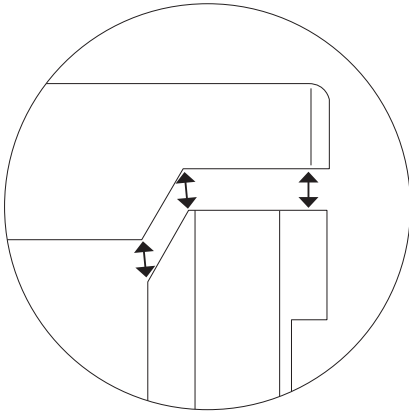

MIN
130mm
5.1"

20mm
3/4"

70mm
2 3/4"

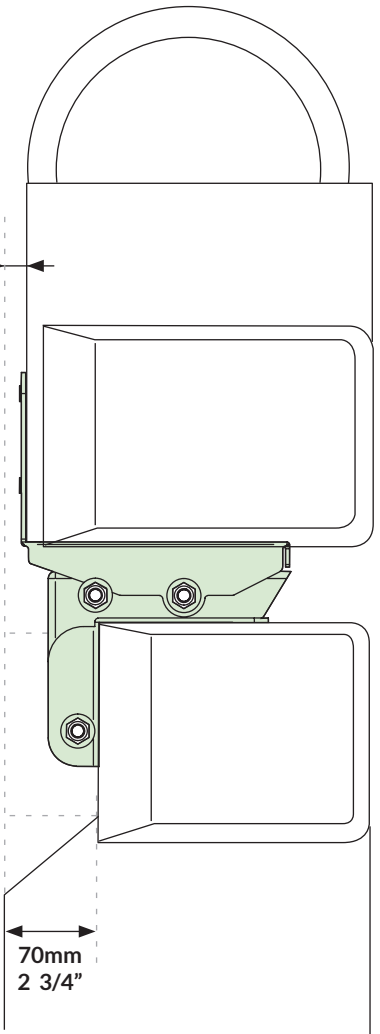

STEP
2

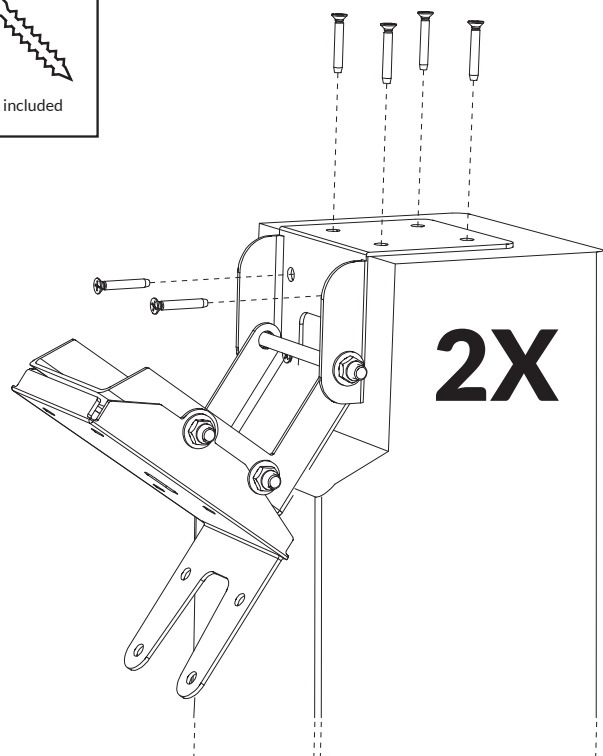
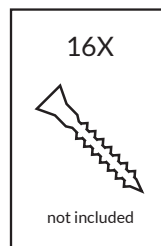
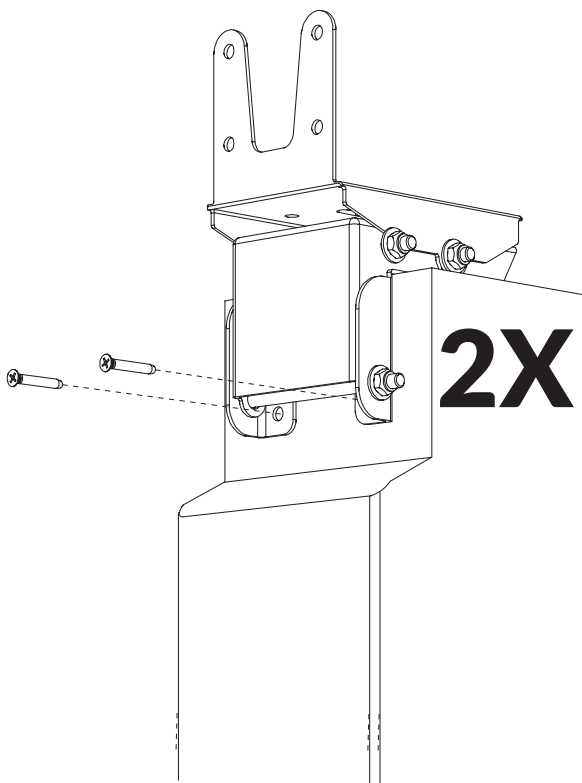

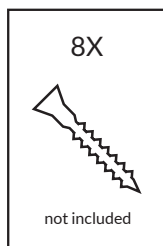

2X

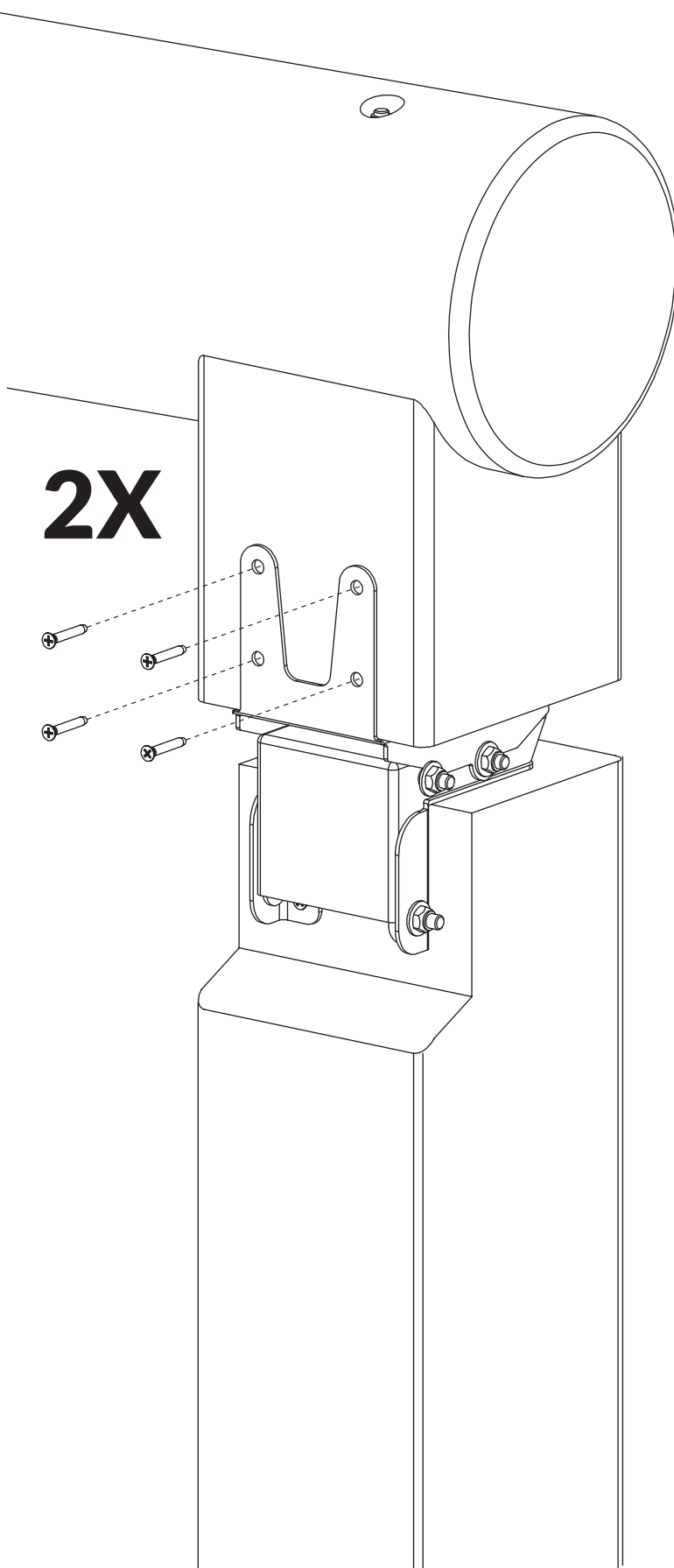



IMPORTANT
USE M12 or UNC 1/2"
to make sure the horizontal rail
is rigid fixed to the posts.

2X

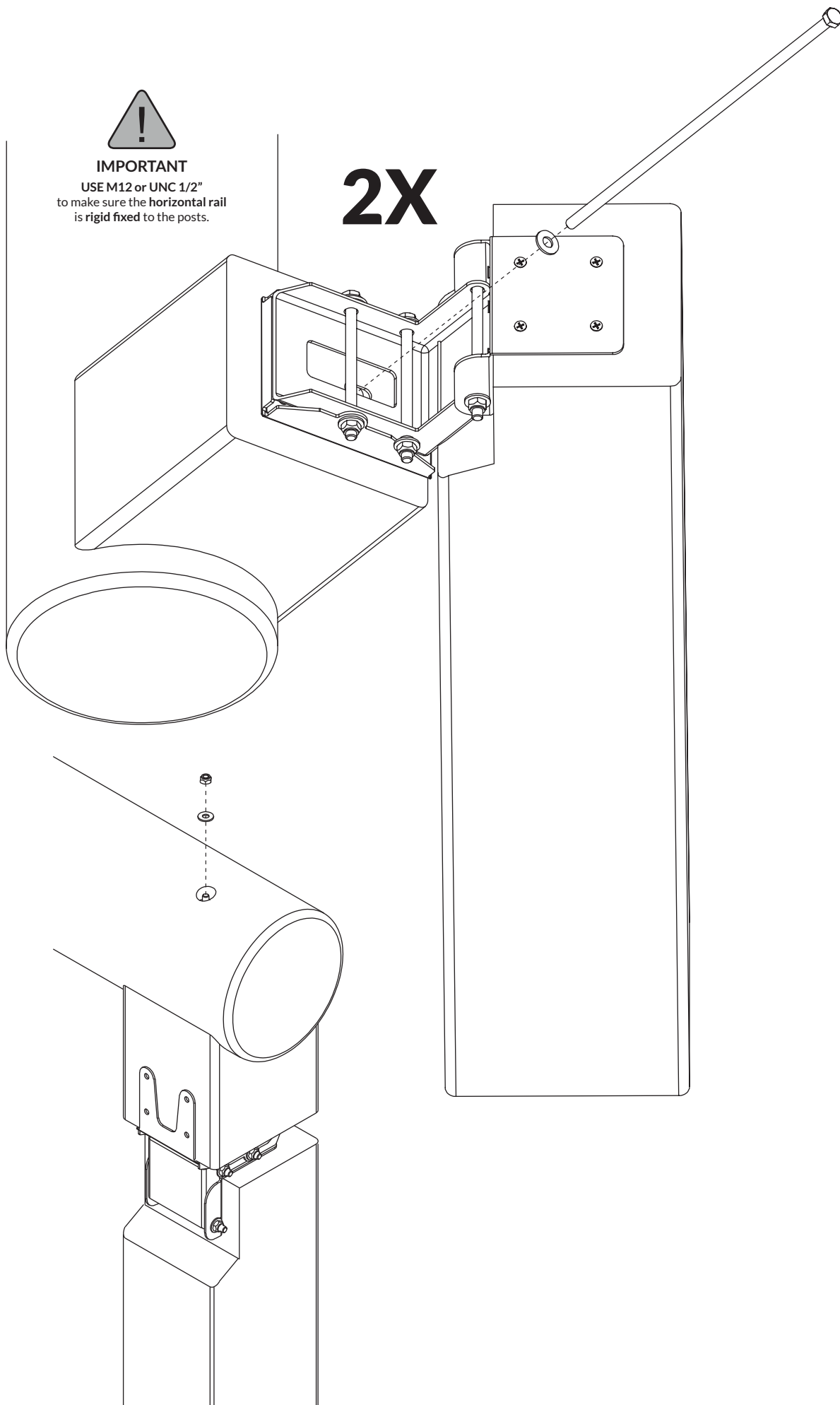

STEP
5

CORRECT alignment of the clip



WRONG alignment of the clip

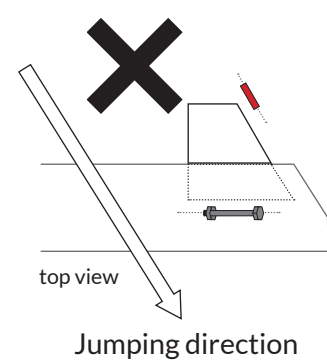

IMPORTANT
USE
Drilling pattern 80326-DP

2X

M-TS10X90
4X



IMPORTANT



Add material to create a flat surface large enough for the clip holders to be placed correctly when round posts are used

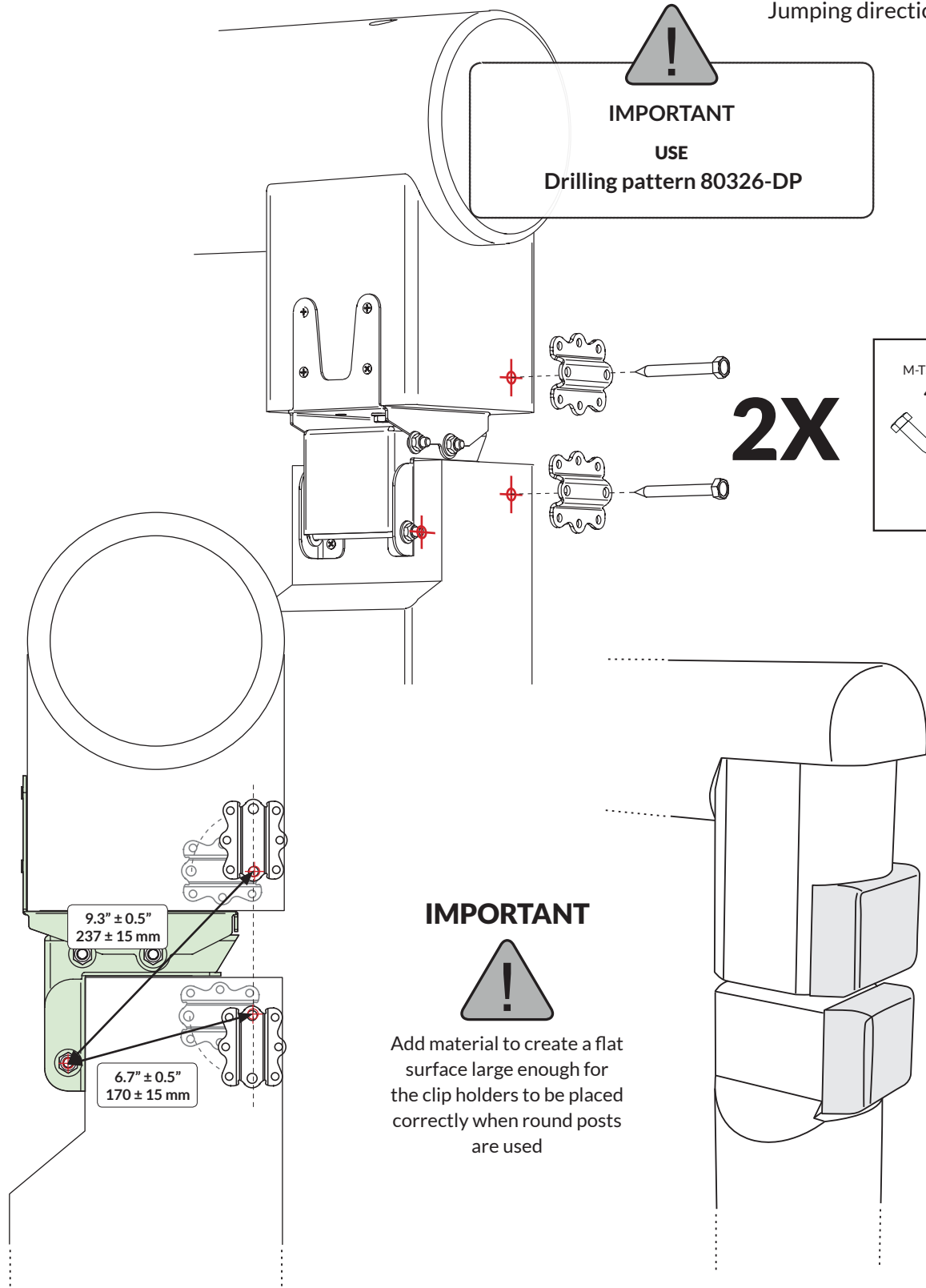

STEP
6

IMPORTANT



Distance between brackets
should be adjusted to avoid
clip C rattling.

2X

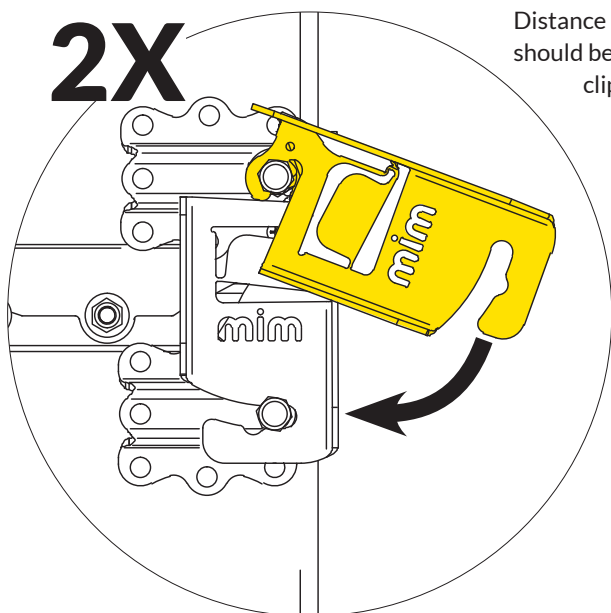

POSITIONING OF CLIP FOR
ANGLED JUMP

order separately
kit nr.80328

2X

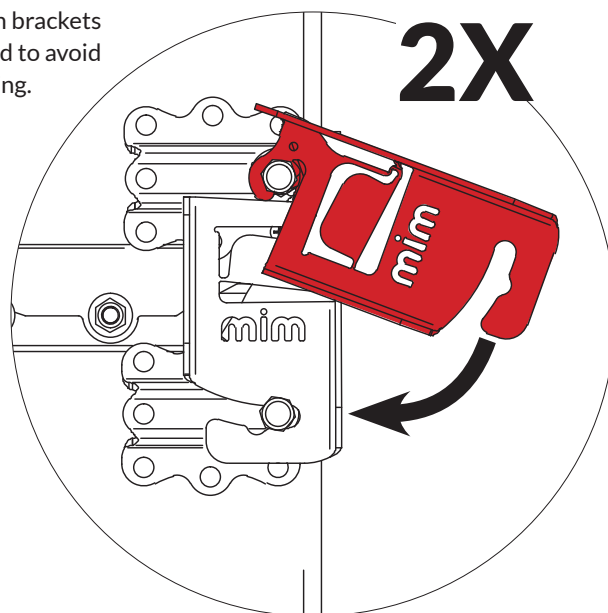

POSITIONING OF CLIP FOR
STRAIGHT JUMP

STEP
7

Rotate the pieces C
around the bolt's position
if necessary

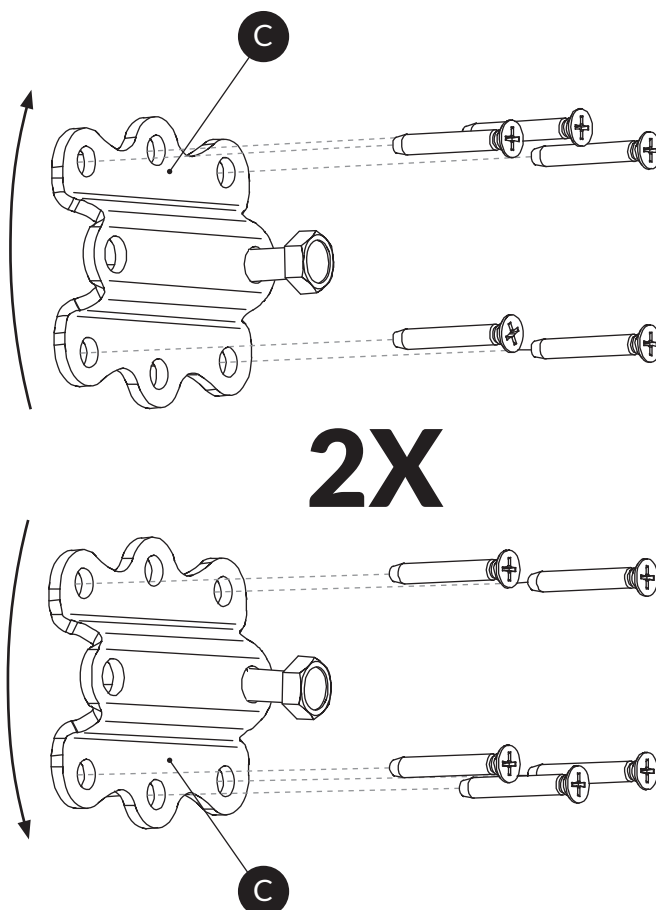

20X

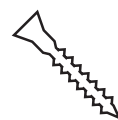

not included



IMPORTANT

When top section is released the distance between top section and ground should be **minimum 200 mm**.

If distance between ground and top section is less, then place an object which will prevent the top section falling into the **SAFE AREA**



The flag is bent when fatigued.

The advantages of the Post & Rail Narrow Kit

1. It has been produced with safety being the first and foremost important factor.
2. Reduces the possibility of rotational falls.
3. FEI approved number FEI12SWE.
4. Controlled movement of fence during release.
5. Reconstruction time is less than 30 seconds.
6. The parts are made of powder coated steel and can be left outside, no maintenance is required.
7. The very highest quality of product from Sweden ISO 9001.

The advantages of the MIMclip

The MIMclip (F18C) breaks on impact. The flag is bent when the clip is exposed to fatigue. In both cases the clip must be replaced. The top section is connected to the post with a hinge that makes the fence easy to reconstruct. This saves time, guarantees fair and correct judging for riders and contributes to the overall safety of the sport.